

SECOND FLOOR PLAN

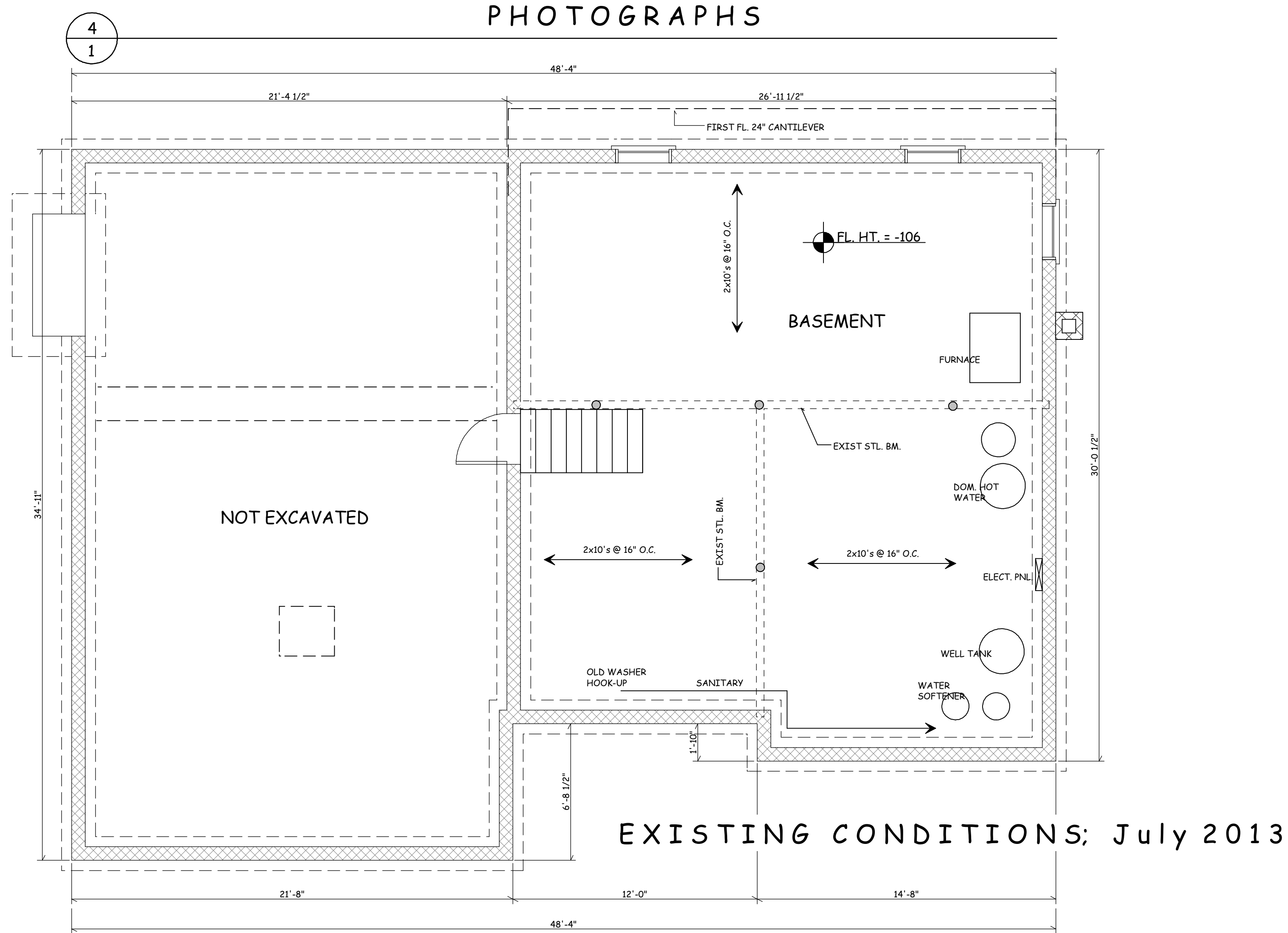

BASEMENT & FOUNDATION PLAN

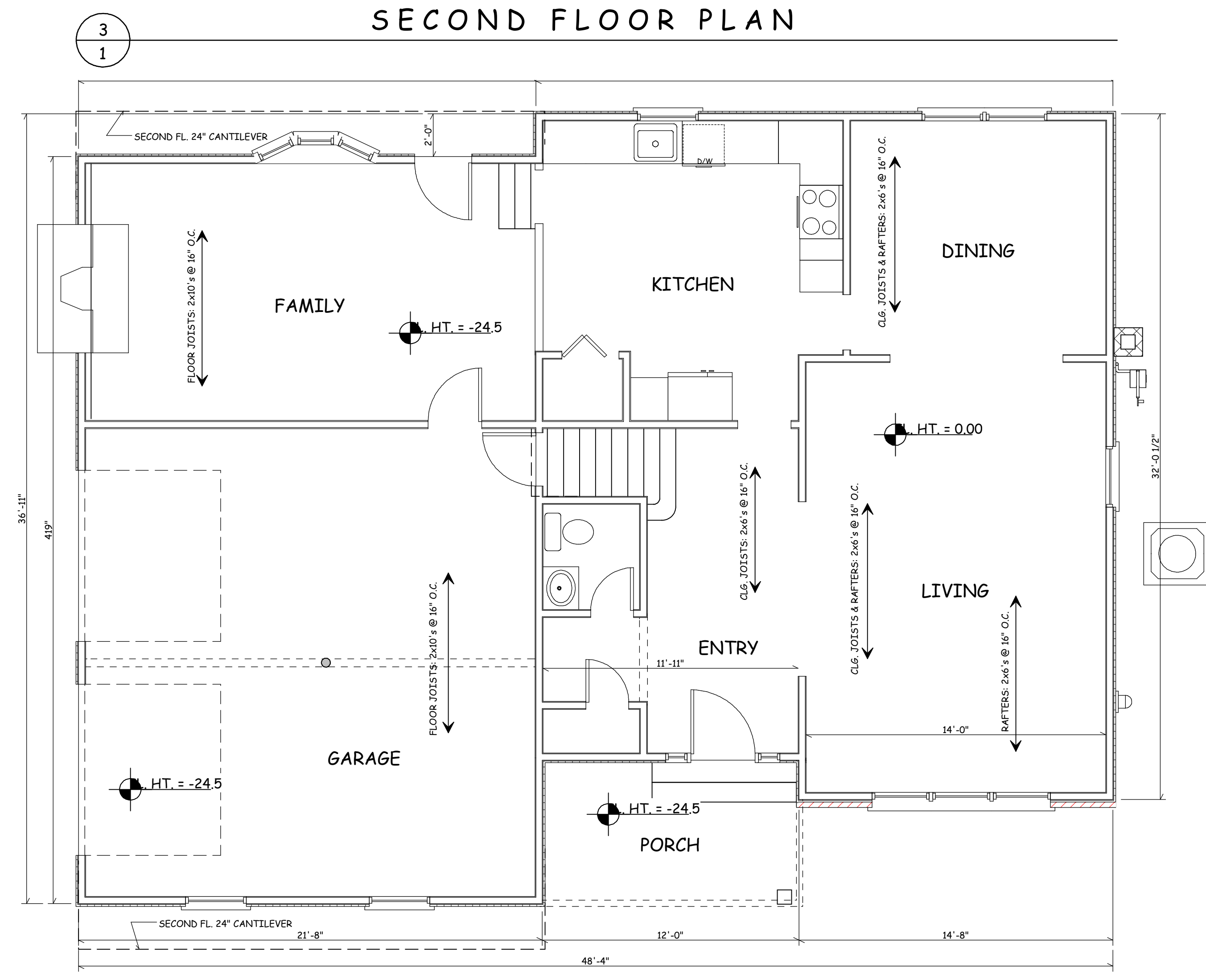

FIRST FLOOR PLAN

PHOTOGRAPHS

REV.#	REVISION DESCRIPTION	DATE
	INTRO TO CLIENT	APRIL 26, 2013
	PROJECT START UP	JUNE 27, 2013
	UPDATES/IN BATH REVISIONS	FEB 10, 2014
	FOR PERMITS	MARCH 03, 2014

PLANS NOT VALID FOR PERMITS UNLESS SIGNED IN 'RED' & IMPRESSED w/ SEAL

Eric C. Van Reed, Architect
 NJ Reg: 21A100908100
Creative Design Associates, Inc.
 ARCHITECTURE INTERIORS SITE & SPACE PLANNING
 350 Callowhill Road
 Chalfont, PA 18914
 215-672-1155
 www.ArchitectVision.com

Ryden Construction
 General Construction
 NJ Reg: H.C. 13VH0609300
 215-822-9239
 RydenConstruction.com
 113 Oak Ave.
 Chalfont, PA 18914

114 HOWARD WAY
 ADDITIONS & ALTERATIONS
 Pennington, 08534
 Hopewell Township, Mercer Co., NJ

Sheet No.
1
 Comm. No. 2013-2974 of 6

SCALE: 1/4" = 1'-0"