

**CASEWORK AND SPECIALTY WORK**

1. THE DESIGN SHOWN IN THE DRAWINGS PROVIDE LAYOUT AND DIMENSIONAL INFORMATION. THIS INFORMATION IS PROVIDED TO ASSIST THE OWNER AND HIS SELECTED CASEWORK FABRICATOR(S) MAKE FINAL DECISIONS REGARDING STYLES, FINISHES, LIGHTING DETAILS, AND ETC.
2. COORDINATE CAREFULLY WITH THE OWNER TO CONFIRM EXACT PRODUCTS TO BE BUILT, PROVIDED, AND/OR INSTALLED.
3. COORDINATE WITH OTHER FINISHES, SUCH AS FLOORS, WALLS, WINDOWS.
4. \*SHOP DRAWINGS\* OR FIXTURE SCHEDULES CONFIRMING ALL DECISIONS ARE HIGHLY RECOMMENDED.
5. COORDINATE WITH PLUMBING, HVAC, AND ELECTRICAL.

**SMOKE DETECTOR SYSTEM:**

2. LOCATIONS SHOWN ARE THE GENERALLY PERCEIVED MINIMUM TO SECURE A BUILDING PERMIT. MANY MUNICIPALITIES HAVE ADDED SPECIAL LOCAL AMENDMENTS NOT PUBLISHED IN THE NATIONAL CODES. THEREFORE, THE LOCAL PLAN REVIEWER MAY REQUIRE ADDITIONAL LOCATIONS AND REQUIREMENTS.
3. INTERNATIONAL RESIDENTIAL CODE SECTION R313 REQUIRED LOCATIONS: IN EACH SLEEPING ROOM AND OUTSIDE EACH SLEEPING AREA IN THE IMMEDIATE VICINITY OF THE BEDROOMS, PLUS ONE ON EACH ADDITIONAL STORY.
4. SYSTEM SPECIFICATIONS: DETECTORS MUST BE HARDWIRED TO A CONSTANT POWER SOURCE AND MUST BE ELECTRONICALLY INTERCONNECTED, SO THAT IF ANY DETECTOR SENDS AN ALARM SIGNAL, THEN ALL DETECTORS SOUND THE ALARM. DETECTORS SHALL HAVE AN EMERGENCY BACKUP POWER SOURCE, GENERALLY BATTERIES.
5. COORDINATE THE INTEGRATION AND INSTALLATION WITH THE OWNER'S SECURITY SYSTEM. PRODUCTS SHALL BE PART OF AN APPROVED LOW VOLTAGE SYSTEM.

**ELECTRICAL SYSTEM NOTES:**

1. LICENSED ELECTRICIANS REGISTERED IN THE MUNICIPALITY SHALL DO ALL WORK IN ACCORDANCE WITH THE LOCAL AND NATIONAL ELECTRICAL CODE. ELECTRICIAN SHALL PROVIDED AN UNDERWRITER'S CERTIFICATE AT THE CONCLUSION OF WORK.
2. ELECTRICIAN SHALL COMPLETE HIS PART OF THE BUILDING PERMIT APPLICATION. IF MUNICIPALITY REQUIRES LOAD CALCULATIONS OR DIAGRAMS, THEN ELECTRICAL CONTRACTOR SHALL PROVIDE.
3. THE MINIMUM WIRE SIZE FOR RECEPTACLES SHALL BE 12 GA., THE MINIMUM WIRE SIZE FOR LIGHTING SHALL BE 14 GA., ALL COPPER. ALL CIRCUITS SHALL BE GROUNDED.
4. LAMPING: ALL NEW FIXTURES SHALL HAVE THE APPROPRIATE LAMP INSTALLED.
5. ELECTRICAL DEVICE DESIGN SHALL BE "DECORA" BY LEVITON, OR APPROVED EQUAL. ALL FACE PLATES SHALL BE MATCHING PLASTIC. ALL DEVICES TO BE WHITE. MOUNTING HEIGHTS, IN GENERAL, USE RECOMMENDATIONS IN THE "ADA" GUIDELINES.
6. ARCHITECT'S DRAWINGS ONLY SHOW ELECTRICAL NOTES, DEVICE LOCATIONS, AND CONTROL SCHEMATICS. THE ELECTRICIAN SHALL DO ALL CIRCUIT & LOAD DISTRIBUTION DESIGN. DISTRIBUTION PANEL SHALL BE CLEARLY LABELED.
7. SEPARATE POWER CIRCUITS FROM LIGHTING CIRCUITS. DO NOT MAXIMIZE CIRCUIT CAPACITY, INSTEAD MAXIMIZE CLARITY OF ORGANIZATION AND SAFETY FOR THE OWNER. DESIGN CIRCUITS SUCH THAT THERE IS ONE (1) BREAKER PER ROOM FOR POWER, LIGHTING MAY BE MORE THAN A SINGLE ROOM, BUT SHALL BE INTELLIGENT ZONES. MAJOR EQUIPMENT, INCLUDING REFRIGERATORS, SHOULD HAVE DEDICATED CIRCUITS.
8. FOR OWNER'S APPROVAL, BEFORE WORK BEGINS, SUBMIT CATALOG CUTS FOR ALL FIXTURES, APPLIANCES, DEVICES, SWITCHES, ETC.
9. COORDINATE WITH THE HVAC CONTRACTOR AND PLUMBING CONTRACTOR TO PROVIDE SERVICE TO ALL EQUIPMENT AS REQUIRED.
10. ALL HOLES DRILLED INTO TOP OR BOTTOM WALL PLATES, INTERIOR AND EXTERIOR, SHALL BE SEALED, USE EXPANDABLE FOAM TO PREVENT VERTICAL PASSAGE OF AIR.

**RECESSED "HIGHHAT" DOWNLIGHTS**

1. RECOMMENDED PRODUCT IS MANUFACTURED BY CREE, #CR6, 6 INCH RECESSED LED KIT. PROVIDES DIMMING CAPABILITY. CAN BE RETROFITTED TO MOST AFG. STANDARD 6 INCH HOUSING. COMPARED TO A 60 WATT INCANDESCENT LIGHT, THIS FIXTURE WILL SAVE \$1 PER MONTH PER UNIT. IT HAS BETTER COLOR THAN COMPACT FLUORESCENT.

**HEATING / COOLING SYSTEM PERFORMANCE SPECIFICATION:**

1. GENERAL: HVAC CONTRACTOR SHALL COMPLETE HIS PART OF THE BUILDING PERMIT APPLICATION. IF MUNICIPALITY REQUIRES SCHEMATICS, CALCULATIONS, DIAGRAMS, OR CATALOG CUTS, THEN HVAC CONTRACTOR SHALL PROVIDE.
2. ALL SYSTEMS REMAIN. EXTEND DUCTWORK TO NEW LOCATION, SEE DRAWINGS AND DIAGRAM.
3. DUCTWORK: ALL DUCTWORK "MAINS" SHALL BE SHEET METAL. BRANCH DUCTWORK IS PREFERRED TO BE SHEET METAL, HOWEVER "FLEX DUCT" WILL BE ACCEPTED IN LIMITED RUNS DIRECT TO DIFFUSERS. ALL SHEET METAL DUCTWORK SHALL BE CAPABLE OF FUTURE "CLEANING," THUS IT SHALL NOT BE INTERNALLY "LINED" WITH ANY SOFT MATERIALS.
4. DUCTWORK: THE IBC ENERGY CONSERVATION CODE REQUIRES THE SEALING OF ALL TRANSVERSE AND LONGITUDINAL DUCT JOINTS TO PREVENT AIR LEAKAGE. USE ROLL LISTING, STANDARD "DUCT TAPE" IS NOT ACCEPTABLE.
5. THERMOSTATS: EXISTING REMAIN OR ADD OPTION FOR NEW LUX MOD# PSPA711. THESE ARE DUAL SETBACK, 7-DAY PROGRAMMABLE, HEATING AND COOLING, WITH BATTERY BACKUP. MAKE SURE CONTROL WIRING FOR BOTH HEATING AND COOLING GETS TO STAT LOCATIONS. ALTERNATES, BUT EQUAL, MAY BE PROPOSED. PROVIDE BEST UNITS AVAILABLE.
6. INSULATION OF DUCTWORK: ALL DUCTWORK INSTALLED IN NON-CONDITIONED SPACE SHALL BE WRAPPED WITH FIBERGLASS INSULATION BATTS WITH VAPOR BARRIERS. MIN. INSUL. VALUE SHALL BE R-19. ALL DUCTWORK INSTALLED IN CONDITIONED SPACE SHALL BE WRAPPED WITH FIBERGLASS INSULATION BATTS WITH VAPOR BARRIERS. MIN. INSUL. VALUE R-8.
7. EXHAUST FANS AND VENTS: SEE ELECTRICAL DRAWINGS FOR EXHAUST FAN LOCATIONS. ALL FANS SHALL BE MIN. 200 CFM. ALL VENTS SHALL BE DIRECT TO THE EXTERIOR THROUGH WALL OR ROOF VENT CAPS PROVIDED WITH GOOD BACK DRAFT PREVENTION. ALL DUCTWORK SHALL BE METALLIC. NO VENTING INTO ATTICS OR SOFFITS ALLOWED.

**FRESH AIR EXCHANGE SYSTEM: ADD OPTION**

1. AS BUILDINGS ARE MADE TIGHTER AND TIGHTER MECHANICAL CODES ARE SUGGESTING THE INTRODUCTION OF EXTERIOR FRESH AIR INTO OCCUPIED ENVIRONMENTS TO PREVENT "SICK BUILDING SYNDROME."
2. INSTALL ENERGY RECOVERING FRESH AIR EXCHANGER. THIS UNIT TO BE A STAND ALONE PACKAGE, DIRECTING AIR TO THE RETURNS OF EACH FLOOR'S AIR HANDLER. DOES NOT HAVE TO BE A HARD CONNECTION. SEE DRAWING FOR LOCATION IN ATTIC. UNIT SHALL NOT RUN CONSTANTLY, BUT SHALL HAVE CONTROL INTERCONNECTION AND RUN ONLY WHEN AIR HANDLERS ARE OPERATING, WITH OVERRIDE.
3. PRODUCT: PERFECTAIRE, MODEL 8100 FRESH AIR EXCHANGER, OR APPROVED EQUAL.

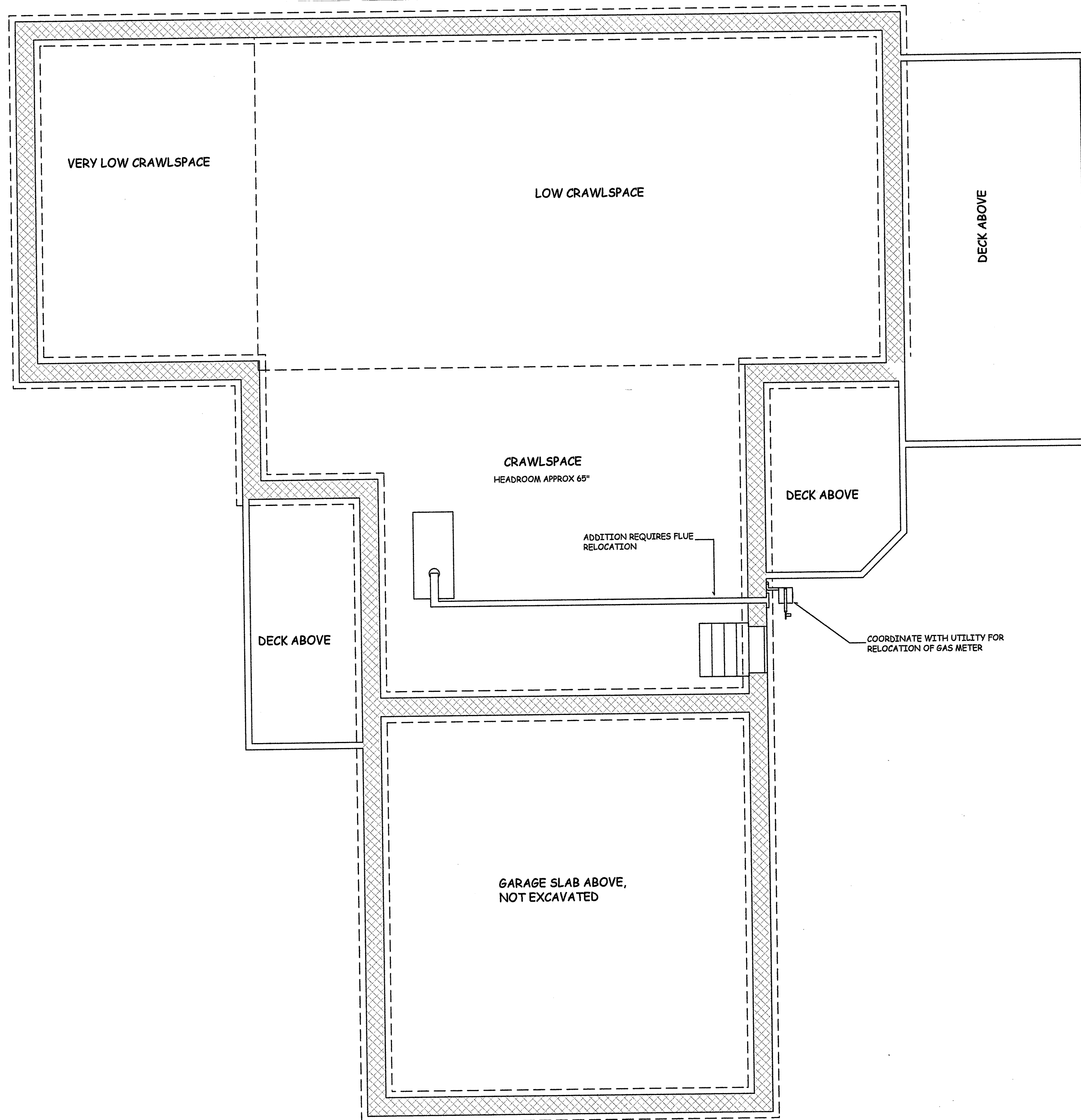

EXISTING FOUNDATION / CRAWLSPACE PLAN

SCALE 1/4" = 1'-0"

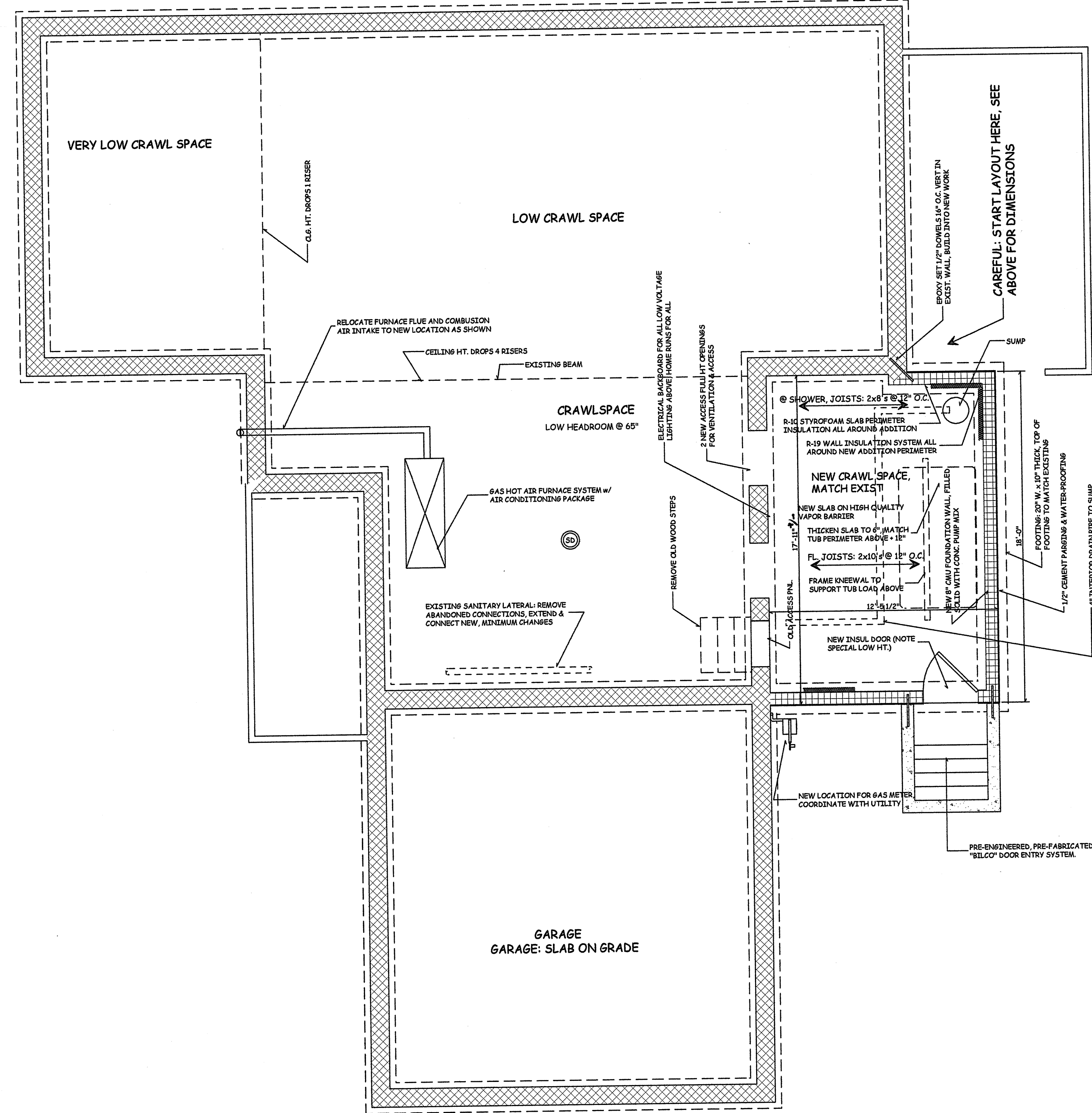

PROPOSED BASEMENT FOUNDATION PLAN

SCALE 1/4" = 1'-0"

2  
3

1  
3

REV. #	REVISION DESCRIPTION	DATE
03-12-2010	START UP	03-12-2010
09-10-2010	REVIEW SET	09-10-2010
10-26-2010	FOR PERMITS	10-26-2010
12-17-2010	FOR CONSTRUCTION	12-17-2010

PLANS NOT VALID FOR PERMITS UNLESS SIGNED IN 'RED' & IMPRESSED w/ SEAL

ALL DRAWINGS ARE FORMATTED FOR FULL SCALE PRINTING ON 24"x36" SHEETS. DO NOT SCALE ANY OTHER SHEET SIZE

Eric C. Van Reed, Architect  
New Jersey Architect 98061

**Creative Design Associates, Inc.**  
ARCHITECTURE INTERIORS SITE & SPACE PLANNING

350 Gallowhill Road  
Chalfont, PA 18814-1521

215-672-1155  
www.ArchitectVision.com

**D. Wesley Rapp**  
General Contracting & Building

526 Danville Road  
Willow Grove, PA 18980

Voice: 215-657-6003  
Fax: 215-657-8018

EXISTING & PROPOSED BASEMENT PLAN @ 1/4" SCALE

**51 Red Oak Drive**  
**MASTER BATH ADDITION**  
Township of Voorhees, Camden County, NJ

Sheet No. **3**

Comm. No. 2010-2913 of